

Fitting of Castor Base

(F-Series)



First carefully lay the cabinet on its back. Before fitting the castor base you need to remove the black plinth which is factory fitted. Please beware of sharp edges inside the unit.

Plinth Removal

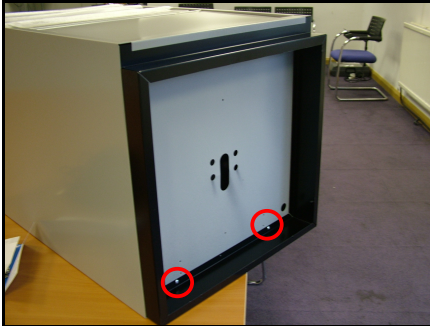

The plinth is fitted to the bottom of the cabinet by 2 screws



Using a cross head screwdriver remove the 2 screws holding the plinth in place.

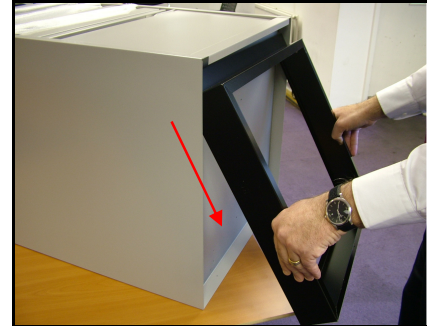

Lift the bottom of the plinth and pull downwards releasing the top from the lip on the cabinet.

Fitting Castor Base



The plinth can then be removed entirely.



Line up the castor base. Please note that the lip on the castor base fits underneath the lip on the front of the cabinet as shown.



Slide the castor base upwards under the lip on the cabinet...



... and fit into place.

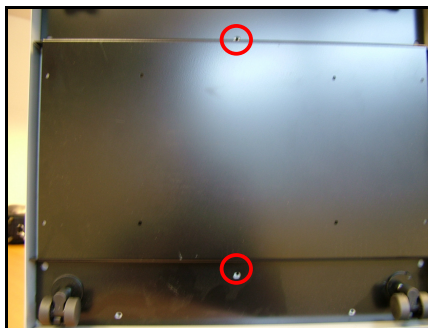

The castor base is held in place by the screws provided in the positions shown above.

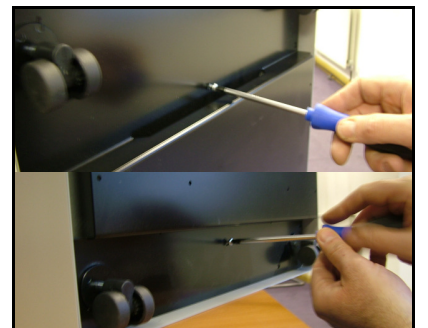

Using a cross head screwdriver fit screws in the positions shown at the top and bottom of the castor base. The base is now fitted and ready for use.