

# Datum File Cart Mobile Storage Assembly Instructions

TOOLS NEEDED FOR ASSEMBLY: PHILLIPS SCREWDRIVER,  $\frac{1}{16}$ " OPEN END WRENCH

HARDWARE INCLUDED:  $\frac{1}{4}$ -20 PAN HEAD PHILLIPS SCREWS (20),  $\frac{1}{4}$ -20 FLANGE NUTS (20), AND CASTERS (4)

1.) Assemble 2 set of angled shelves. Position shelf back and shelf bottom together and using (2)  $\frac{1}{4}$ -20 flange nuts and pan head Phillips screws. Tighten screws.

2.) Attach 2 sets of angled shelves to cart sides. Attach angled shelves using (8)  $\frac{1}{4}$ -20 pan head screw and (8)  $\frac{1}{4}$ -20 flange nuts (4 per side, per shelf) to the cart sides, do not tighten screws until all 16 screws in both shelves have been started.

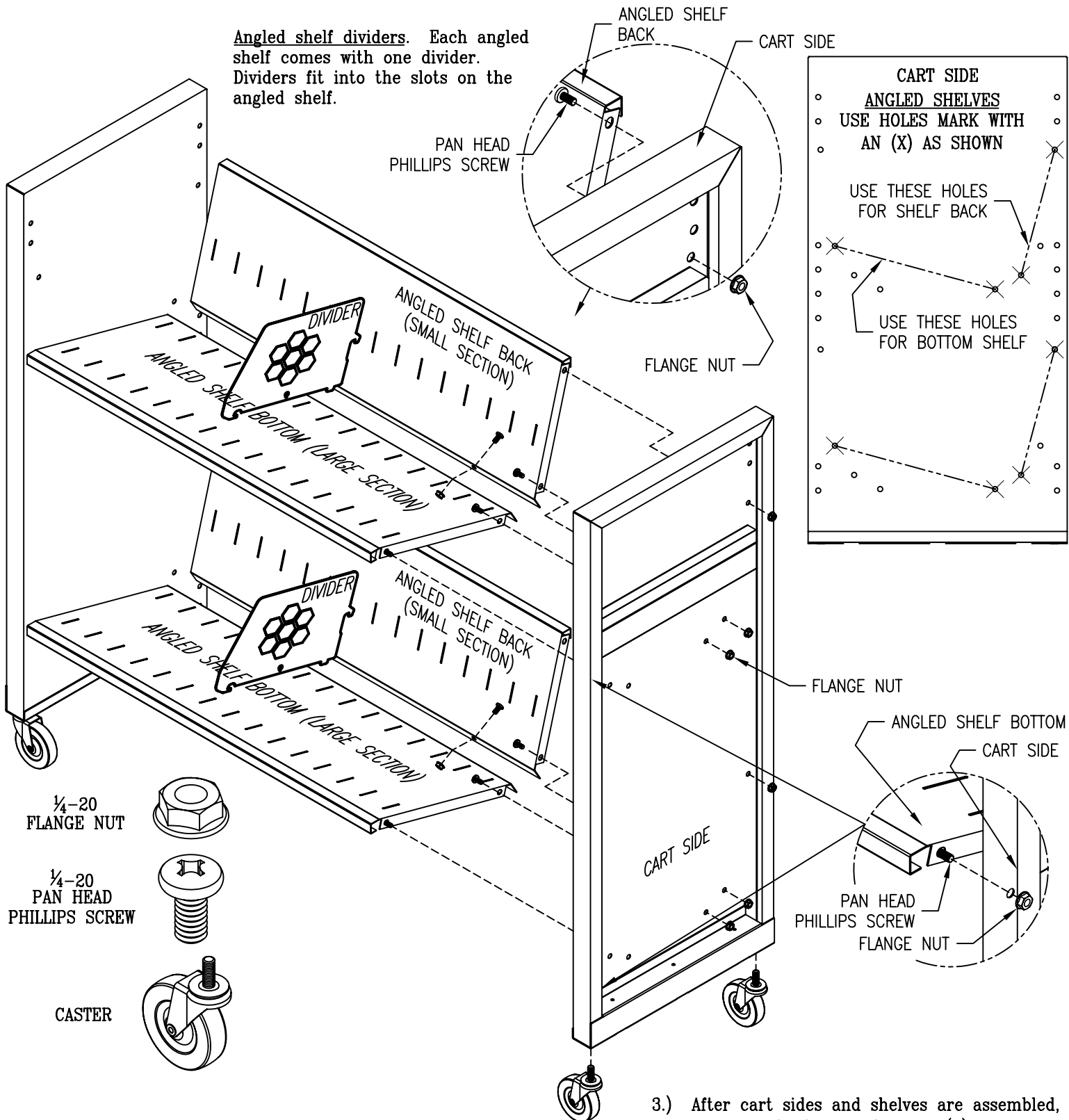

3.) After cart sides and shelves are assembled, turn unit upside down and insert (4) casters into sockets on bottom of cart.

# Datum File Cart End Panels Assembly Instructions

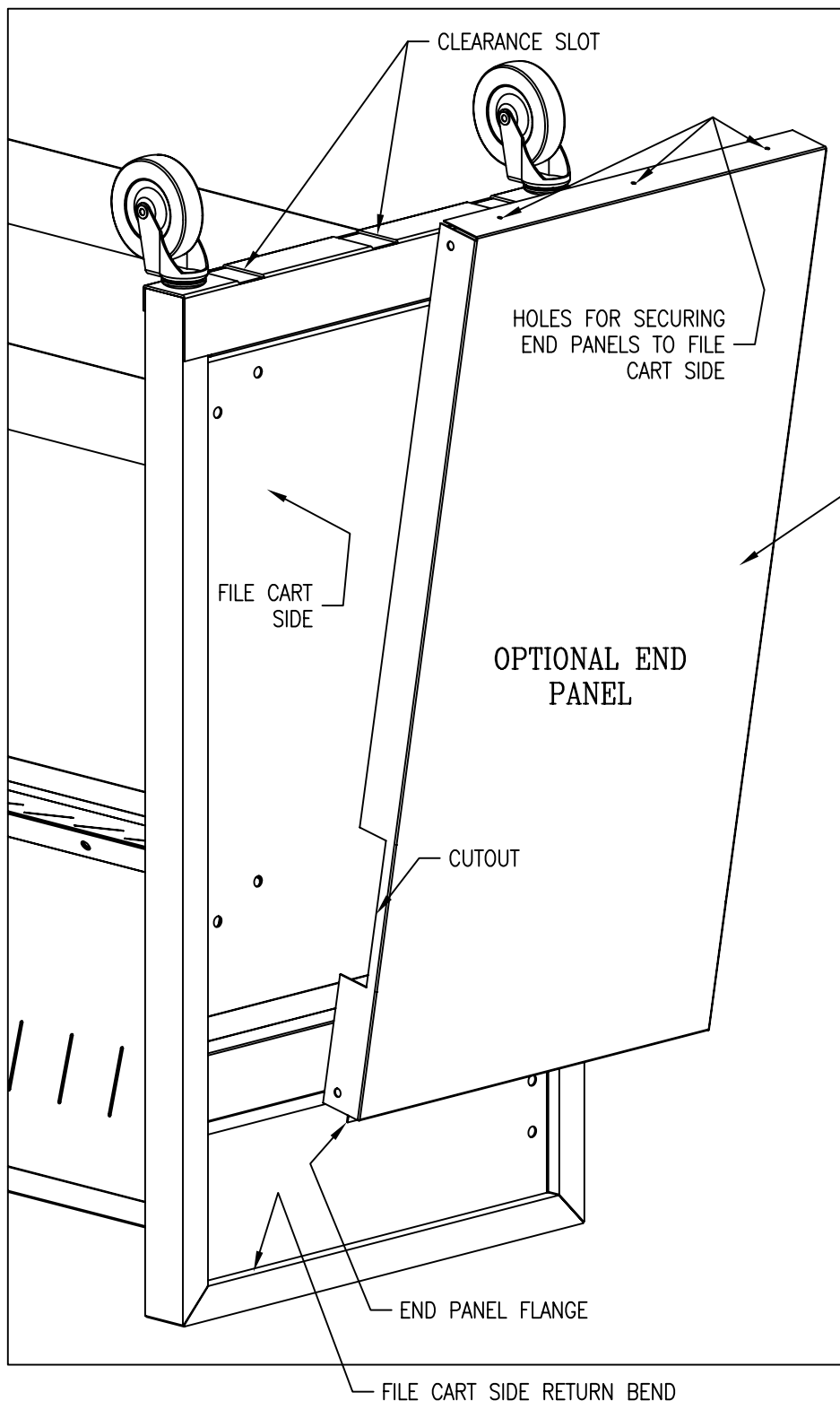

1.) Flip file cart upside down (as shown). Take end panel and with cutout down slide flange on end panel behind return bend on file cart side. Push end panel into file cart side.

2.) Secure end panel to file cart side using (3) #8 x 1/2" sheet metal screws inserted through the clearance slots in file cart side and into end panel.

3.) Repeat steps (1 & 2) for other side of cart.

END PANEL

#8 x 1/2"  
SHEET METAL  
SCREW

